

SLP_{60Hz}

In-line Circulator Pumps

SLP Series is Vertical in-line Centrifugal pump in-line port position with flange designed according to DIN Standard. Standard pumps are fitted with motor according to IEC standard, with three phase premium efficiency (IE3).



SLP
General Data

Model Code	1
Applications	1
Features	1
Pumped Liquids	1
Operation Conditions	1
Motor	1
Motor Data	2
Materials	2

Technical Data

SLP 32	3
SLP 40	5
SLP 50	7

SLP In-line Circulator Pumps

SLP Series is Vertical in-line Centrifugal pump, in-line port position with flange designed according to DIN Standard. Standard pumps are fitted with motor according to IEC standard, with three phase premium efficiency (IE3).



Model Code

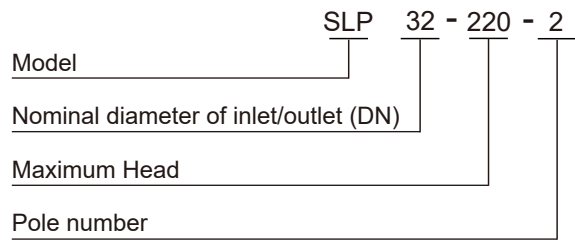

Applications

- Hot or chilled water circulating systems
- Refrigerating systems
- Domestic and potable water system
- Industrial Water services
- Circulation and supply of potable, domestic, sanitary, brackish water, and other clean aggressive liquids.

Pumped Liquids

The pump is suitable for thin, clean, non-aggressive and non-flammable liquids, not containing solid particles or fibres that may attack the pump mechanically or chemically.

Operation Conditions

- Flow Rate : Up to 34 m³/h
- Head : Up to 40 m
- Liquid Temperature Range : -25 To +120 °C
- Maximum Ambient Temperature : +50 °C
- Maximum Operating Pressure : 16 (bar)

Motor

The motor fitted on SLP pumps is a totally enclosed, fan-cooled motor with main dimensions to IEC and DIN standards.

Electrical tolerances to IEC 60034.

- Relative humidity : Maximum 95 %
- Enclosure class : IP55
- Insulation class : F

Features

- Optimised Hydraulics For High Efficiency
Reduced power consumption.
- High-efficiency Motors
SLP pumps are fitted with high-efficiency motors.
- High-efficiency motors offer reduced energy consumption.
SLP pumps are primarily fitted with motors that meet the legislative requirements of the EuP IE3 grade.
- Top-pull-out Design
Easy dismantling in case of service.
- In-line Design
Contrary to end-suction pumps, in-line pumps allow straight pipes and thus often reduced installation costs.
- Pump Housing And Pump Head Are Electrocoated To Improve The Corrosion Resistance
- Stainless steel Impeller And Neck Ring
Wear-free operation with high efficiency.

Motor Data

Motor Type				Nominal current in [A]					IE class
Pole	HP	kW	Flange	Frame	3 ϕ				
					Δ 220-255V	Y380-440V	Δ 220-277V	Y380-480V	
2	0.5	0.37	B14 / V18	71A	1.7-1.7	1.0 - 1.1	—	—	IE3
	0.75	0.55		71B	2.4-2.4	1.4-1.4	—	—	IE3
	1.0	0.75		80A	3.1-3.1	1.8-1.8	—	—	IE3
	1.5	1.1		80B	4.0-3.5	2.3-2.0	—	—	IE3
	2.0	1.5		90S	—	—	5.7-5.4	3.3-3.1	IE3
	3.0	2.2		90L	—	—	8.1-7.2	4.7-4.2	IE3
	4.0	3.0		100L	—	—	11.1-9.7	6.4-5.6	IE3

Materials

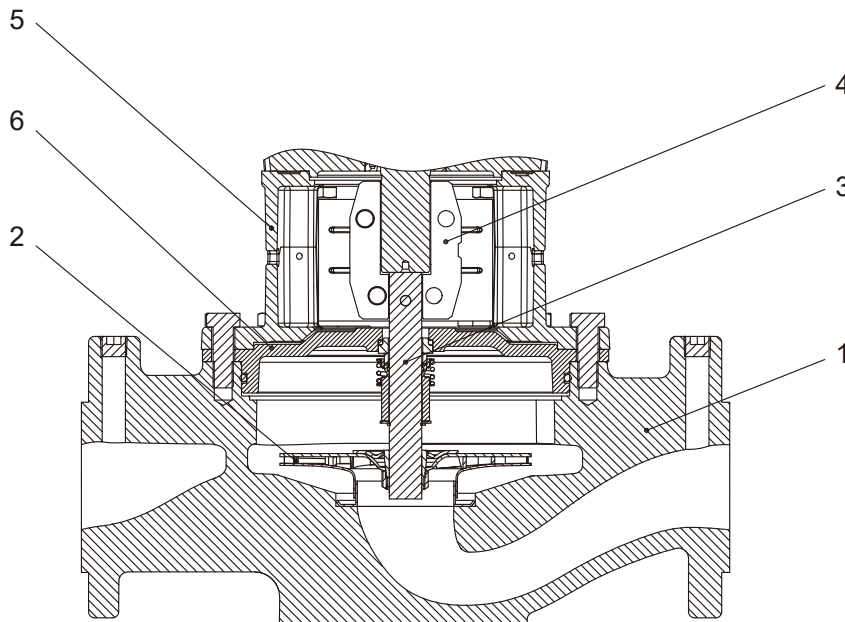

Pos.	Component	Material	EN/DIN
1	Pump housing	Cast iron FC250	0.6025
2	Impeller	Stainless steel	1.4301
3	Shaft	Stainless steel	1.4301
4	Coupling	Fe-Cu-C FC0525 (MPIF) Cast iron FCD450	0.7045
5	Pump head	Cast iron FC250	0.6025
6	Pump head cover	Cast iron FC250	0.6025
	Secondary seals	EPDM	
	Rotating seal face	Carbon (resin-impregnated) silicon carbide	
	Stationary seat	silicon carbide	

Performance Curves

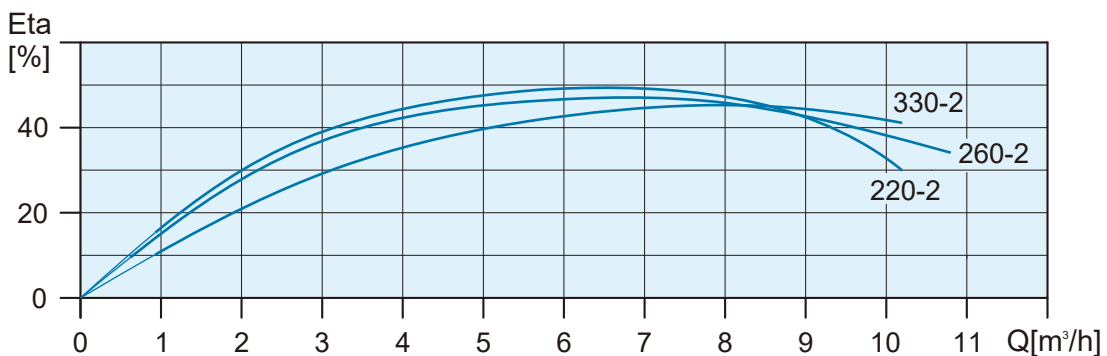
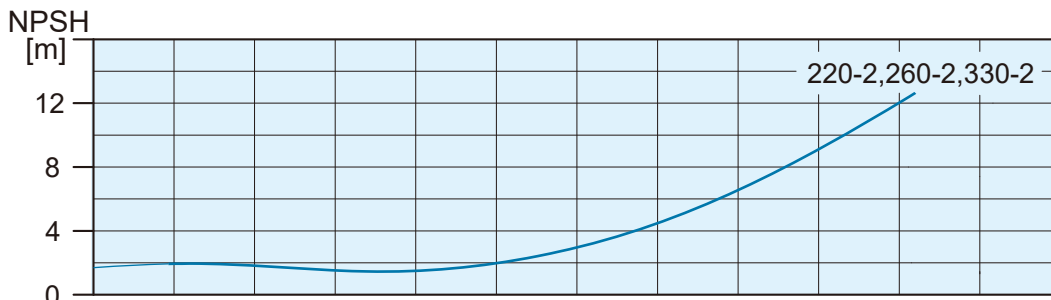
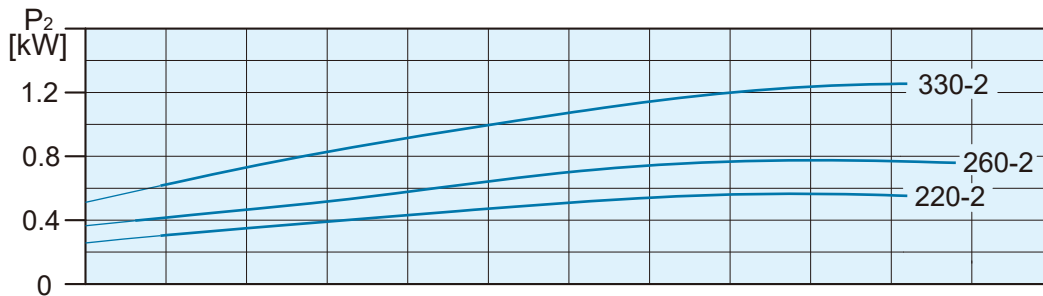
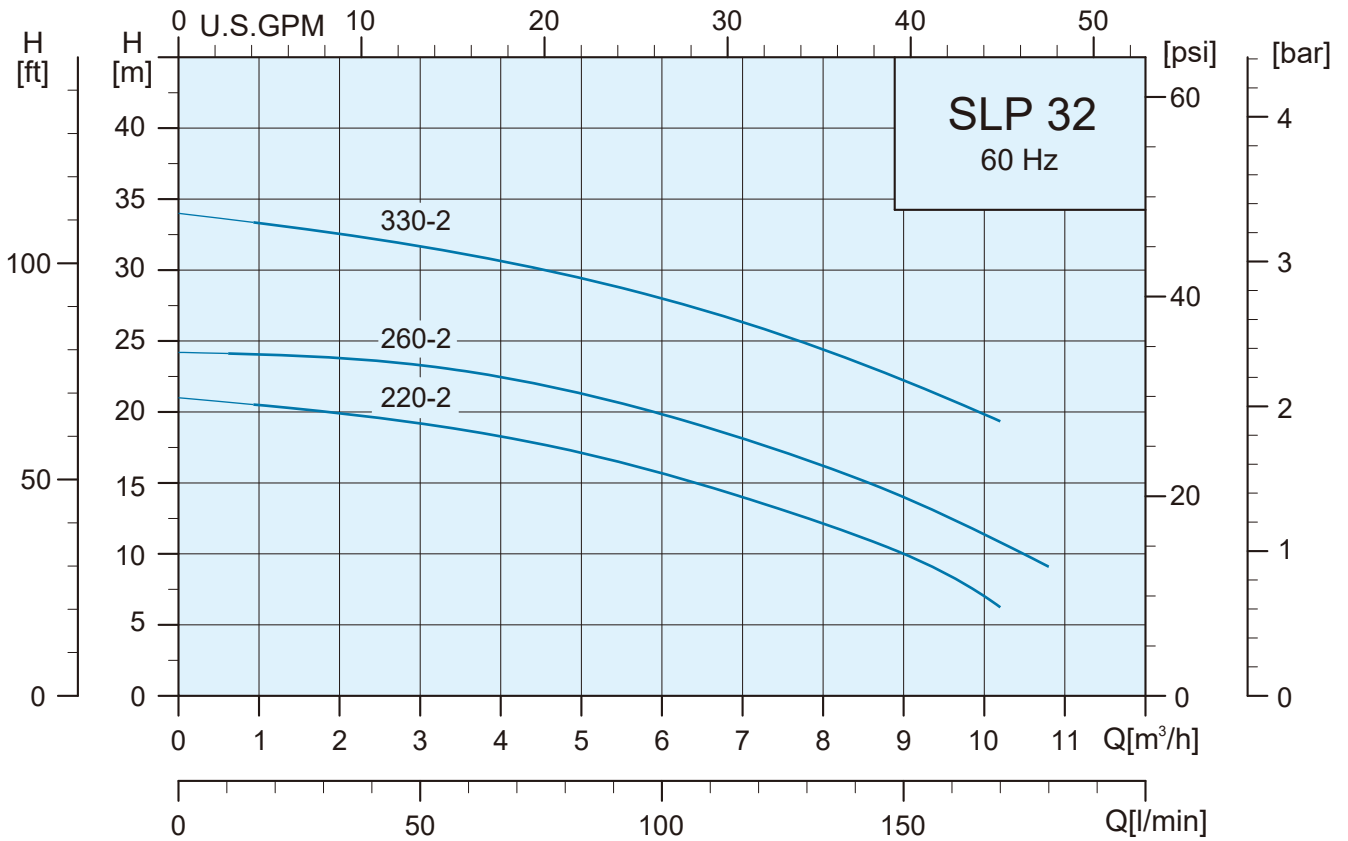

Specifications

Model	Power		Head (Pressure)		Flow (Capacity)	Connection	T _{min} / T _{max}
	P ₂		Rated(m)	Max.(m)	Rated(m ³ /h)	Inlet / Outlet	°C
	kW	HP					
SLP 32-220-2	0.75	1.0	14.2	21.0	6.9	DN32	-25 / 120
SLP 32-260-2	1.1	1.5	17.2	24.0	7.5	DN32	-25 / 120
SLP 32-330-2	1.5	2.0	24.0	34.0	8.2	DN32	-25 / 120

Dimensions and Weights

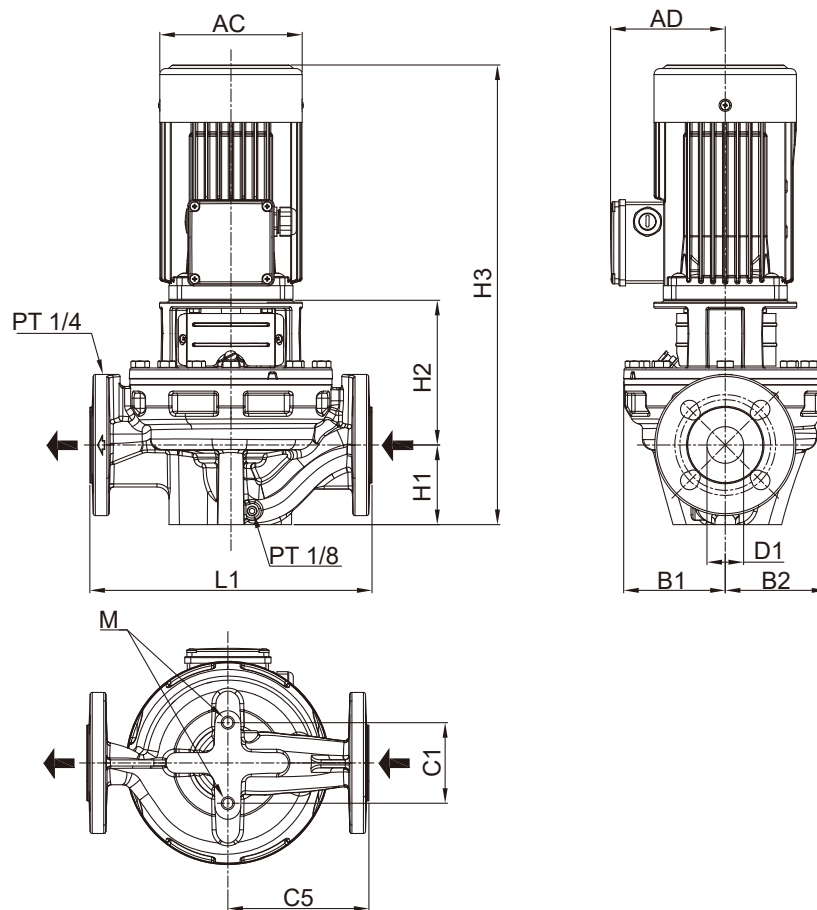

Model	Series	Flange		Dimension (mm)												Net Weight (kg)
		DIN	JIS	D1	AC	AD	B1	B2	C1	C5	L1	H1	H2	H3	M	
SLP 32-220-2	200	PN 6/10	10K	32	141	115	101	101	80	140	280	79	145	457	M12	24
SLP 32-260-2	200	PN 6/10	10K	32	141	115	101	101	80	140	280	79	145	477	M12	27
SLP 32-330-2	200	PN 6/10	10K	32	177	141	101	101	80	140	280	79	154	530	M12	34

Performance Curves

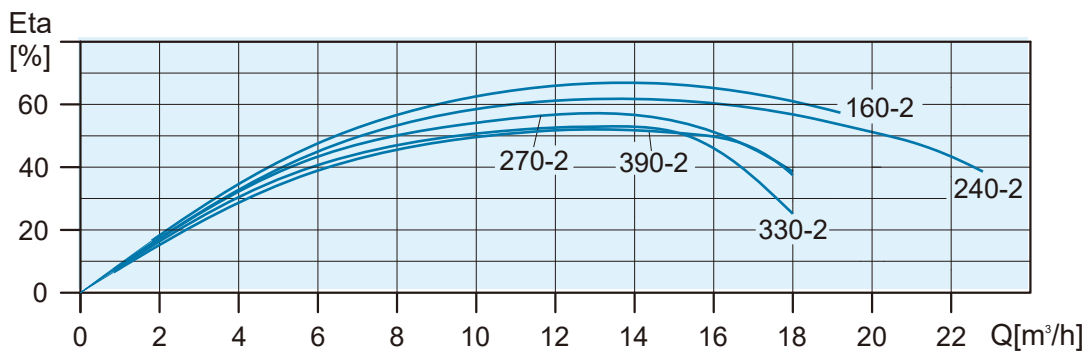
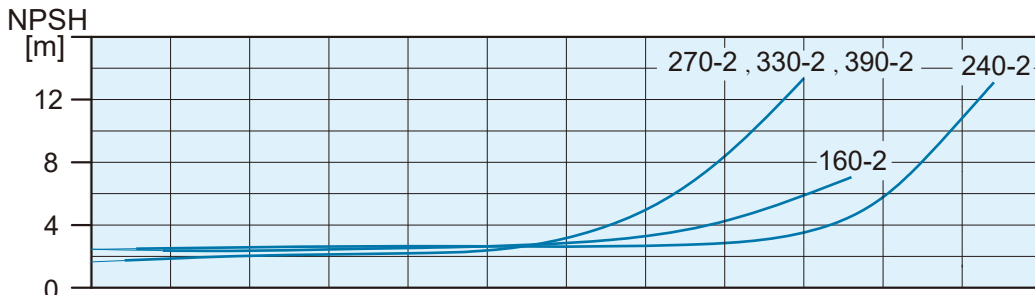
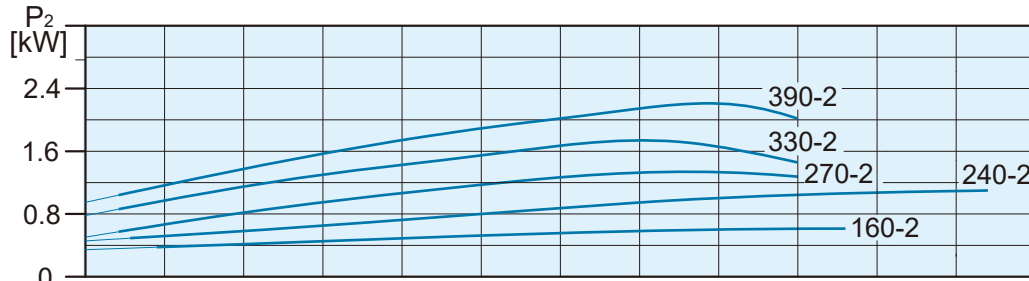
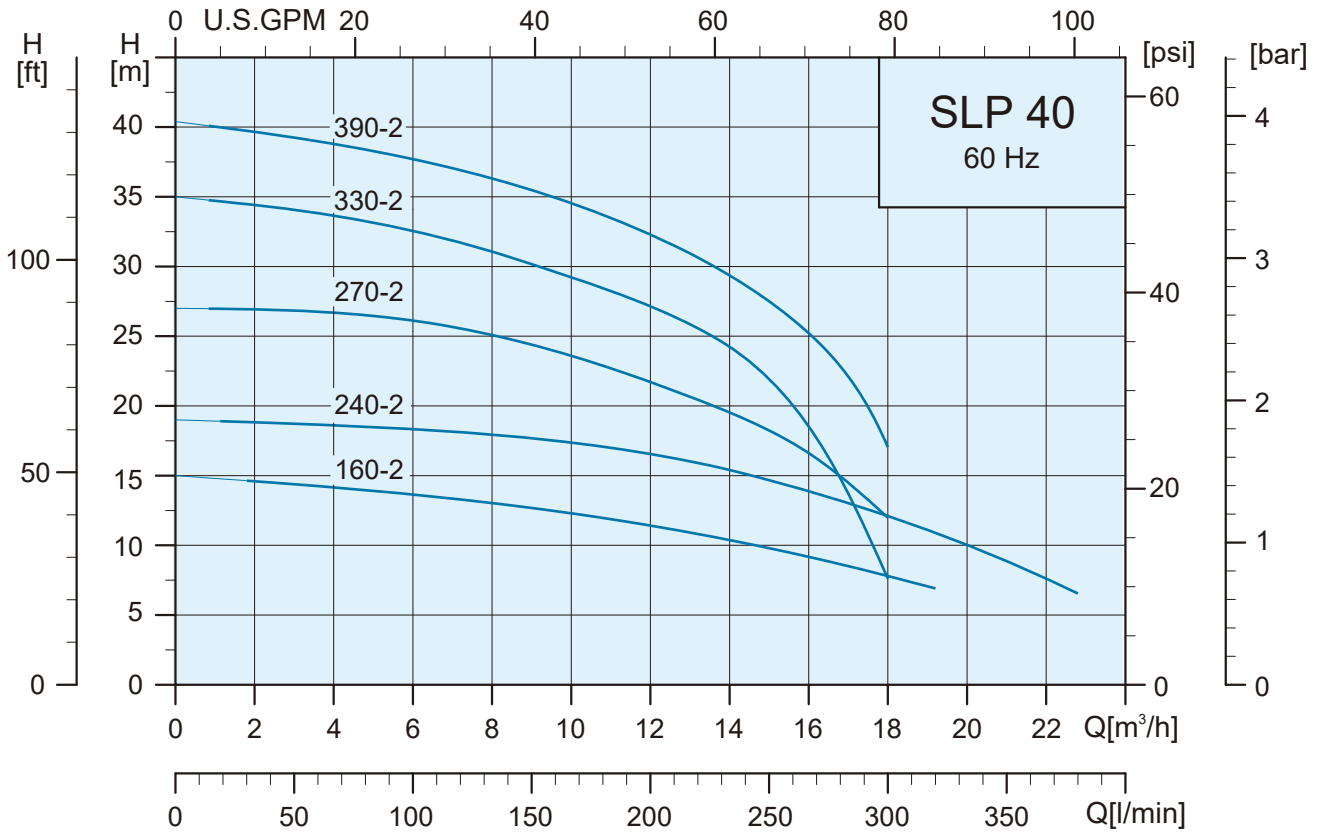

Specifications

Model	Power		Head (Pressure)		Flow (Capacity)	Connection	T _{min} / T _{max}
	P ₂		Rated(m)	Max.(m)	Rated(m ³ /h)	Inlet / Outlet	°C
	kW	HP					
SLP 40-160-2	0.75	1.0	10.6	15.0	13.6	DN40	-25 / 120
SLP 40-240-2	1.1	1.5	15.8	19.0	13.4	DN40	-25 / 120
SLP 40-270-2	1.5	2.0	20.6	27.0	13.1	DN40	-25 / 120
SLP 40-330-2	2.2	3.0	23.0	35.0	14.6	DN40	-25 / 120
SLP 40-390-2	3.0	4.0	27.5	40.0	15.0	DN40	-25 / 120

Dimensions and Weights

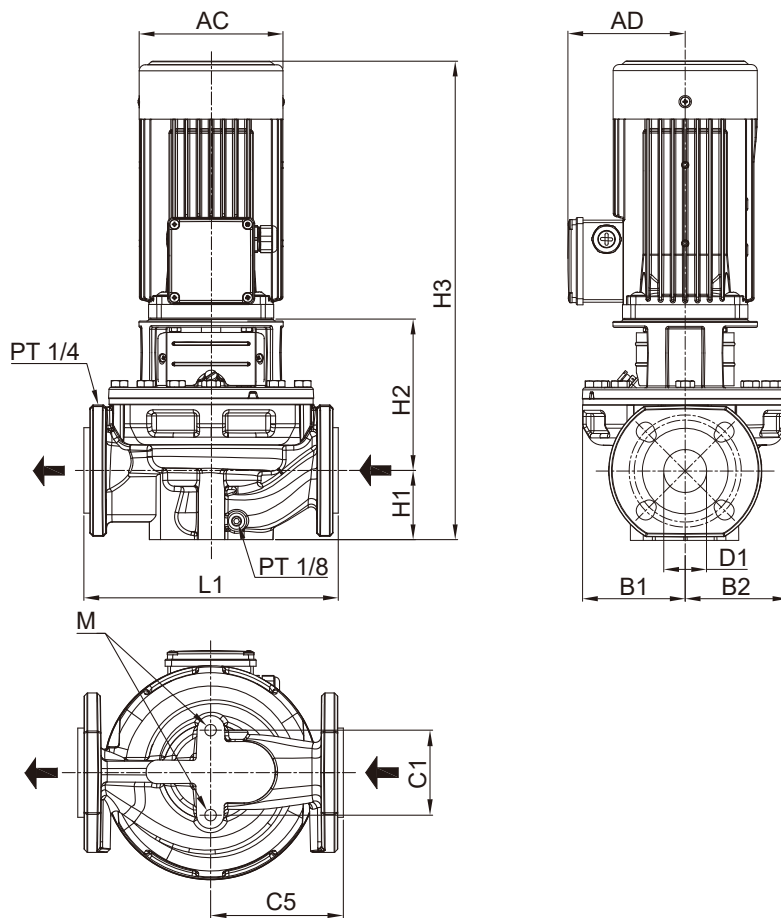

Model	Series	Flange		Dimension (mm)												Net Weight (kg)
		DIN	JIS	D1	AC	AD	B1	B2	C1	C5	L1	H1	H2	H3	M	
SLP 40-160-2	200	PN 6/10	10K	40	141	115	76	76	80	125	250	67	148	448	M12	21
SLP 40-240-2	200	PN 6/10	10K	40	141	115	101	101	80	125	250	68	150	471	M12	26
SLP 40-270-2	200	PN 16	10K	40	177	141	101	101	120	160	320	68	156	521	M12	34
SLP 40-330-2	200	PN 16	10K	40	177	141	101	101	120	160	320	68	156	521	M12	38
SLP 40-390-2	200	PN 16	10K	40	197	147	101	101	120	160	320	68	166	552	M12	45

Performance Curves

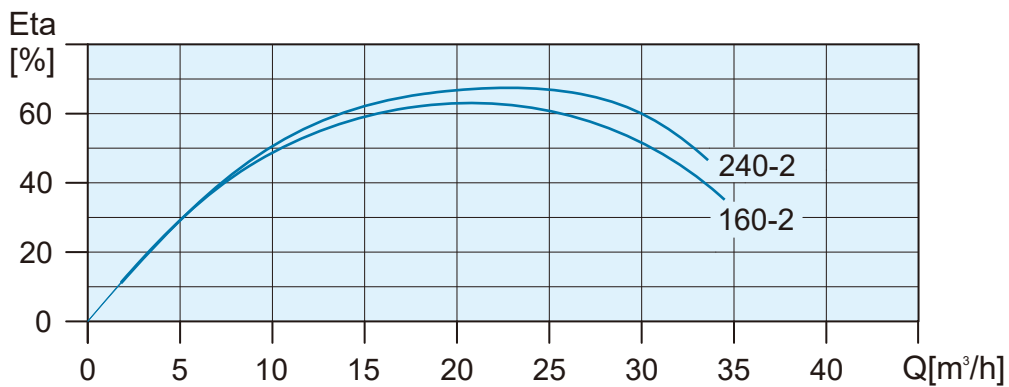
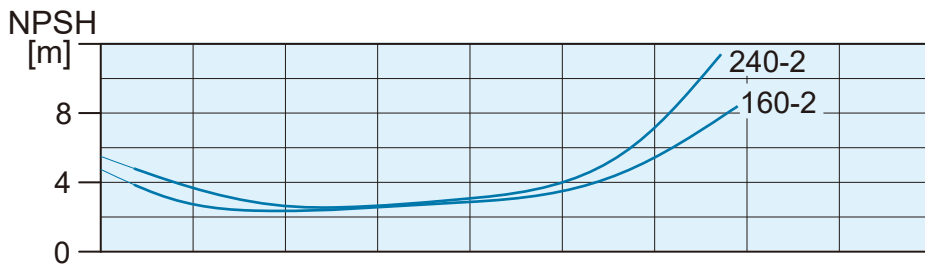
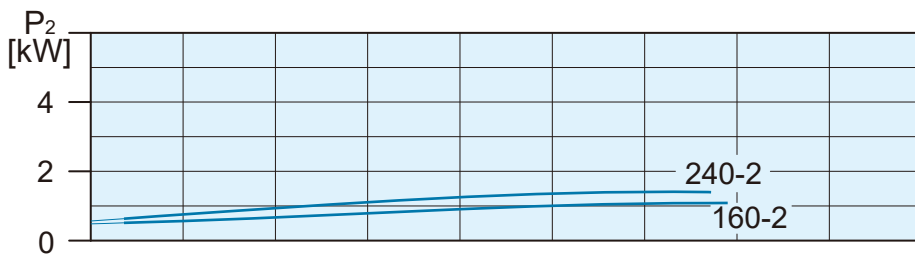
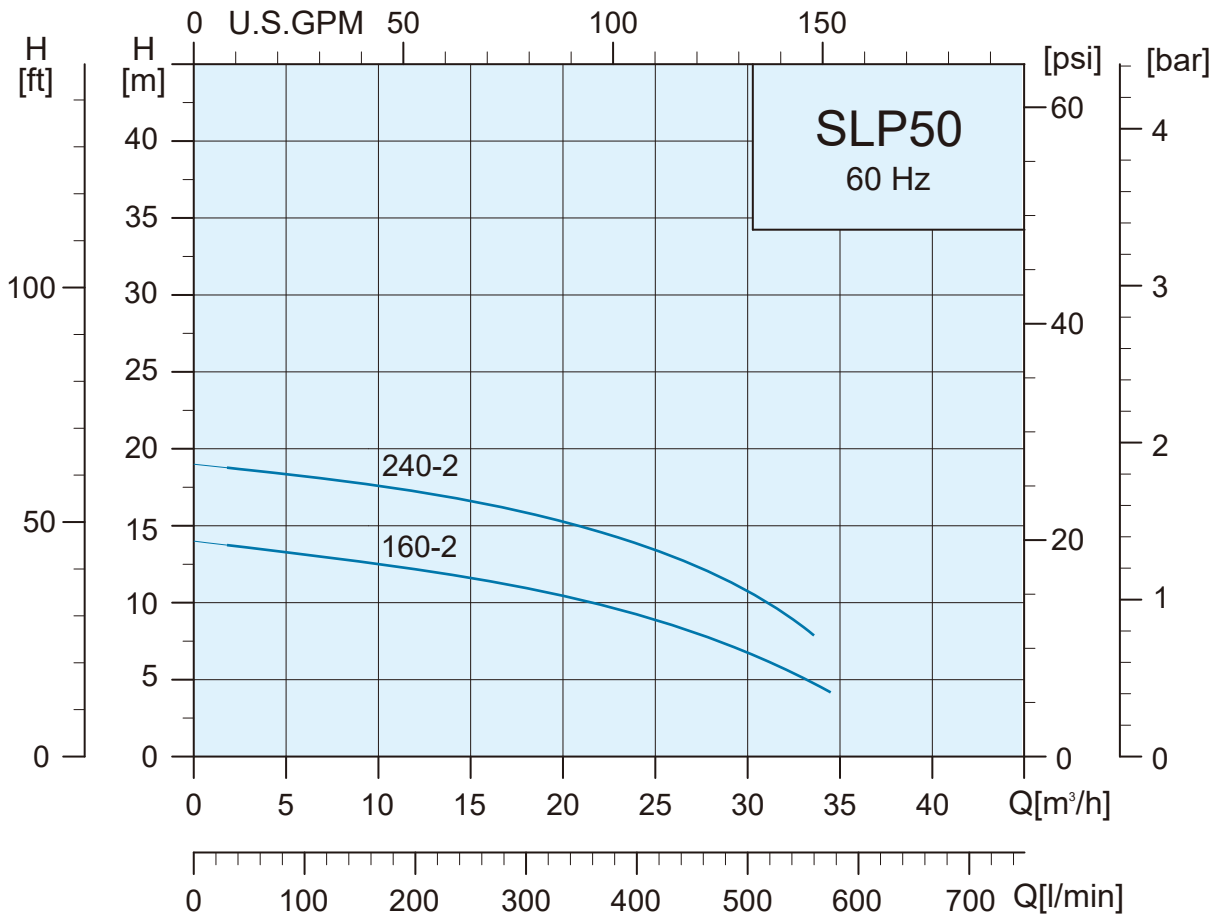

Specifications

Model	Power		Head (Pressure)		Flow (Capacity)	Connection	T _{min} / T _{max}
	P ₂		Rated(m)	Max.(m)	Rated(m ³ /h)	Inlet / Outlet	°C
	kW	HP					
SLP 50-160-2	1.1	1.5	10.2	14.0	20.9	DN50	-25 / 120
SLP 50-240-2	1.5	2.0	14.6	19.0	22.0	DN50	-25 / 120

Dimensions and Weights

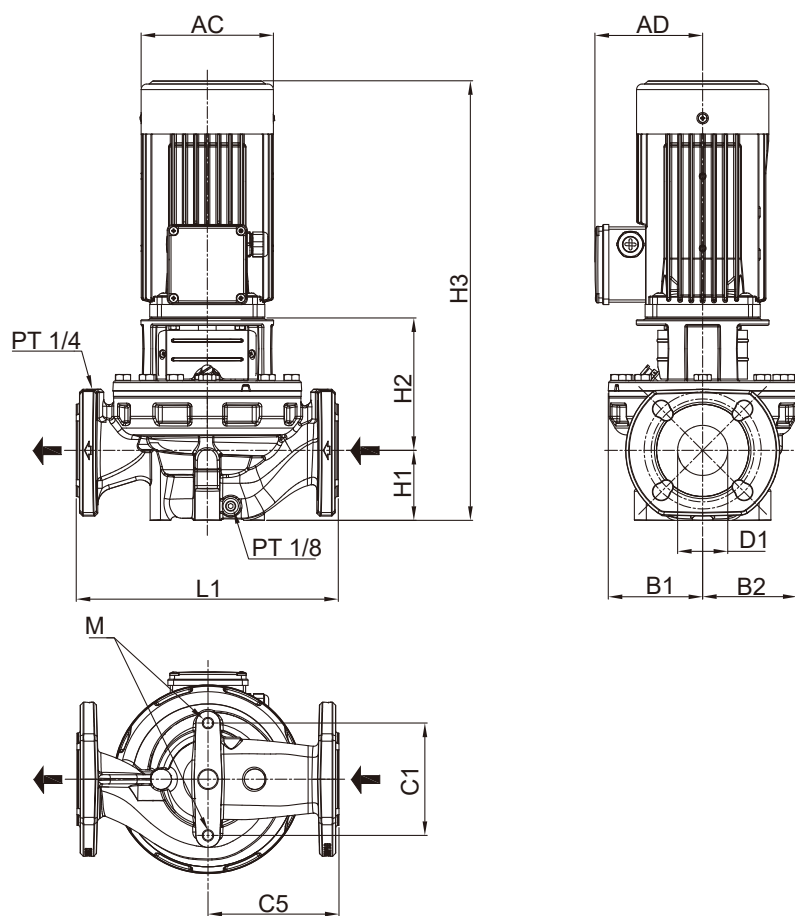

Model	Series	Flange		Dimension (mm)												Net Weight (kg)
		DIN	JIS	D1	AC	AD	B1	B2	C1	C5	L1	H1	H2	H3	M	
SLP 50-160-2	200	PN 6/10	10K	50	141	115	101	101	120	140	280	75	142	470	M12	28
SLP 50-240-2	200	PN 6/10	10K	50	177	141	101	101	120	140	280	75	151	523	M12	35



 **STAIRS**

No.6-7-1,Shanzijiao, Lucao Township, Chiayi County 61158, Taiwan
Tel: +886 5 3750488 Fax: +886 5 3755658
www.stairs.com.tw E-mail:stairs@stairs.com.tw

1120103

